

# BUCCANEER BOND ISSUE 2007

## EAST CHAMBERS INDEPENDENT SCHOOL DISTRICT



### ELEMENTARY SCHOOL UPGRADES

Miscellaneous  
 \*Elementary Parking  
 \*Road Asphalt and Bus Shed  
 \*Security/Safety Upgrades  
 \*New Wall Panels at Elementary Classroom Building  
**\$500,000**

Elementary Multipurpose Building  
 \*Classrooms  
 \*Nurse  
 \*Speech  
 \*Motor Skills  
 \*Teacher Workroom  
**\$1,250,000**

Elementary Gym Remodel  
**\$88,000**

New Playground Equipment  
**\$28,000**  
**\$60,000**

Elementary Parking

FEAR ROAD

Security

Elementary Restroom Remodel  
**\$12,730**

New Elementary Building  
**\$900,000**

New Wall Panels

K+1 Heating  
**\$33,000**

Sidewalk Canopy

New Bus Turn Around  
**\$66,900**

Elementary HVAC Projects  
**\$445,443**

**KEY**

2007 PROPOSED BOND ISSUE PROJECTS AND UPGRADES

PROJECTS COMPLETED IN THE LAST 10 YEARS WITH FUND BALANCE SAVINGS



### NEW ELEMENTARY CLASSROOM BUILDING

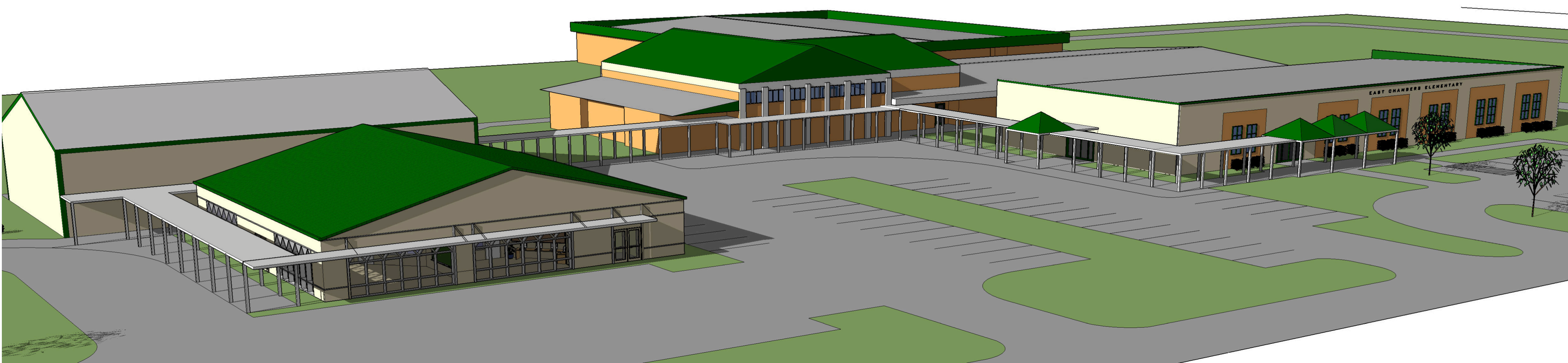
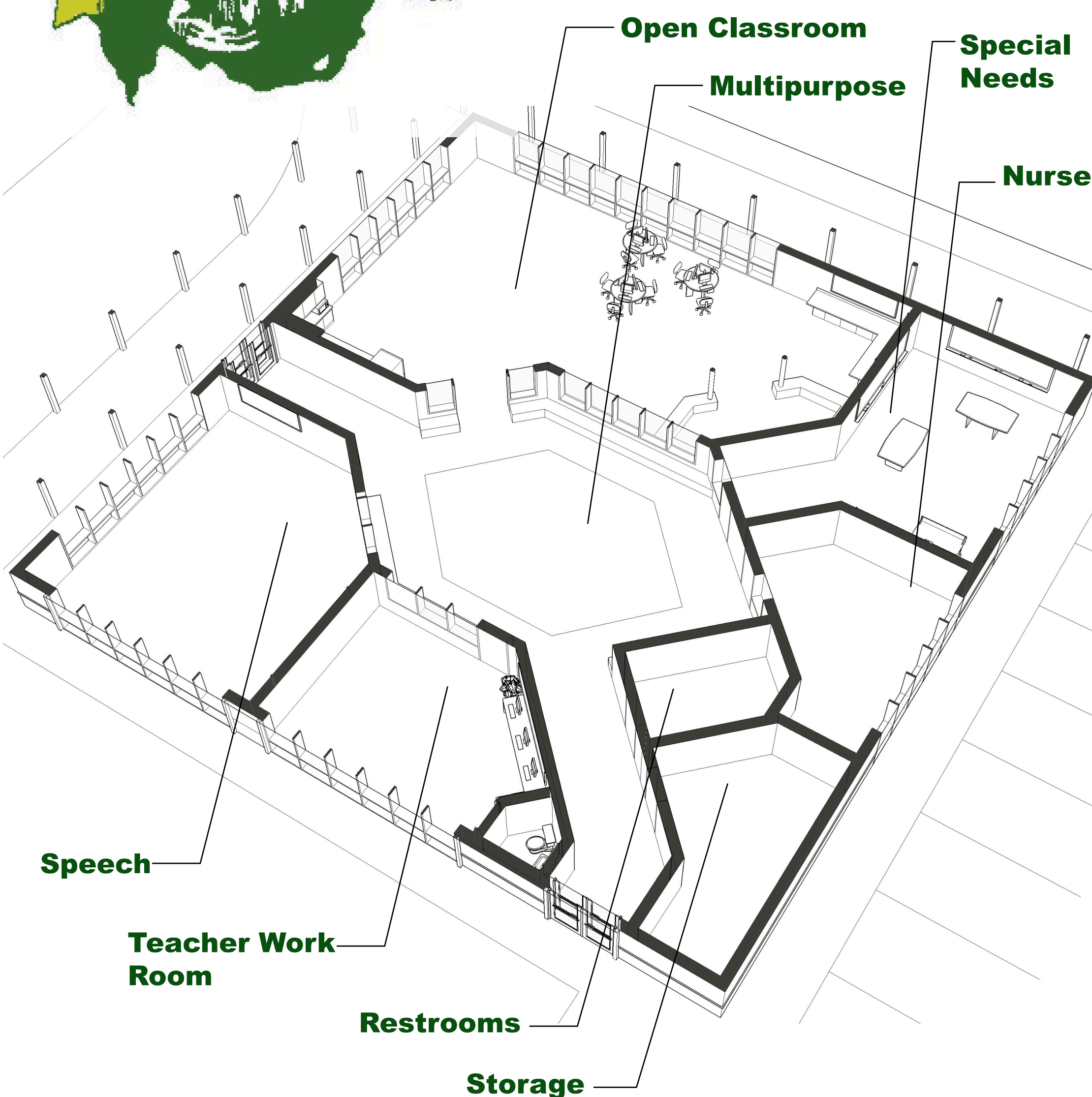

#### WHAT ARE THE PROPOSED PROJECTS?

- Proposition 1**
- East Chambers Elementary School
    - New Classroom Construction
    - Renovation of the 1962 Classroom Building
    - Covered Play Area Behind Elementary on Existing Pad
    - Additional Walkways, Parking, HVAC Projects
  - East Chambers Intermediate/Junior
    - Renovation of the 1948 Classroom Building
    - Renovation of the 1978 Science Building
    - New Bleachers in the 1978 Junior High Gym
    - Additional Walkways
  - East Chambers High School
    - Renovation of the 1957 Senior Wing and Science Labs
    - Renovation of the 1957 Auditorium
    - Renovations in the 1957 Main Building
  - East Chambers ISD Athletic Facilities
    - Renovate and Air-Condition the 1957 High School Gym
    - Renovate Football Stadium Complex, New Bleachers, Concessions, Restrooms
    - Construction of a Softball Field and Lighting Baseball Field
  - East Chambers ISD
    - Upgrade Security System
    - Upgrade Energy Control System
    - Paving Bus Area Parking and Road
    - Cover for Buses
- Proposition 2**
- New High School Gymnasium

#### WHAT IS THE PROJECTED TAX IMPACT?

East Chambers ISD historical and projected tax rates:

1998/99	\$1.470	(M&O = \$1.47 and I&S = \$0.00)
1999/00	\$1.450	(M&O = \$1.45 and I&S = \$0.00)
2000/01	\$1.450	(M&O = \$1.45 and I&S = \$0.00)
2001/02	\$1.430	(M&O = \$1.43 and I&S = \$0.00)
2002/03	\$1.430	(M&O = \$1.43 and I&S = \$0.00)
2003/04	\$1.410	(M&O = \$1.41 and I&S = \$0.00)
2004/05	\$1.410	(M&O = \$1.41 and I&S = \$0.00)
2005/06	\$1.410	(M&O = \$1.41 and I&S = \$0.00)
2006/07	\$1.290	(M&O = \$1.29 and I&S = \$0.00)
2007/08	\$1.040	(M&O = \$1.04 and I&S = \$0.00)

One of the following rates will be levied if any or both of the bond propositions pass:

2008/09	\$1.360**	(M&O = \$1.04 and I&S = \$0.320)
2008/09	\$1.250**	(M&O = \$1.04 and I&S = \$0.210)
2008/09	\$1.225***	(M&O = \$1.04 and I&S = \$0.185)
2008/09	\$1.165****	(M&O = \$1.04 and I&S = \$0.125)

\*Includes the new bonds if the voters approve both propositions.  
 \*\*Includes the new bonds if the voters approve proposition 1 only.  
 \*\*\*Includes the new bonds with state aid for both propositions.  
 \*\*\*\*Includes the new bonds with state aid for proposition 1.

The East Chambers ISD tax rate has declined 43¢ since the 1998/99 school year.  
 If approved by the voters, Proposition 1 for \$6,000,000 will require a tax rate of approximately 21¢ with a 20 year amortization. If approved by the voters, Proposition 2 for \$3,500,000 will require a tax rate of approximately 11¢ with a 25 year amortization.

**WHAT ABOUT POTENTIAL STATE ASSISTANCE?**  
 Under a state funding program, the district is potentially eligible for state assistance on the annual bond payment. Under the current formula for the program, the state assistance will total approximately 40% of the annual bond payment. This state assistance will occur if the Texas Legislature takes action to roll forward an existing program and if they do take this action again, it will result in a reduction of the required tax rate for the bonds. With state assistance, Proposition 1 will require a tax rate of approximately 12.5¢ and Proposition 2 will require a tax rate of approximately 6.5¢.

#### WHAT ABOUT TAXPAYERS WITH FROZEN SCHOOL TAXES?

This bond issue will not affect the taxes of anyone 65 and older or disabled with the Homestead School Tax Freeze. For these folks with a school tax freeze, their school taxes will be lower this fall as a result of the constitutional amendment approved by Texas voters in May. Their taxes will remain frozen at the lower level and will not be increased regardless of the outcome of the bond election.

#### HOW WILL THE BALLOT READ?

**Proposition 1**  
 FOR or AGAINST:  
 "THE ISSUANCE OF \$6,000,000 OF SCHOOL BUILDING BONDS FOR THE CONSTRUCTING, RENOVATING, ACQUIRING, AND EQUIPPING SCHOOL FACILITIES IN THE DISTRICT AND THE ACQUISITION OF SITES FOR SCHOOL FACILITIES, AND THE LEVYING OF A TAX IN PAYMENT THEREOF."

**Proposition 2**  
 FOR or AGAINST:  
 "THE ISSUANCE OF \$3,500,000 OF SCHOOL BUILDING BONDS FOR THE CONSTRUCTING, RENOVATING, AND EQUIPPING SCHOOL FACILITIES IN THE DISTRICT, TO WIT: CONSTRUCTING A NEW HIGH SCHOOL GYMNASIUM, AND THE LEVYING OF A TAX IN PAYMENT THEREOF."

**OTHER FACTS**  
 In addition, the bonds will be issued with a 10-year redemption feature. The redemption feature provides the district with the option to pay off all or a portion of the bonds after 10 years if there are available funds to do so. As the district has done in the past, excess revenues may be used to either repay the bonds early or reduce the I&S tax rate.

The District has grown approximately 25% since 1991 with additional programs and services.

School Districts Contiguous to ECISD	2007/08 Total Tax Rate	Local Homestead Exemption
Hamshire-Fannett ISD	\$1.3380	0%
High Island ISD	\$1.3000	0%
Sabine Pass ISD	\$1.1771	20%
Anahuac ISD	\$1.1672	20%
Hardin-Jefferson ISD	\$1.1400	15%
East Chambers ISD	\$1.0400	20%
Devers ISD	\$0.9872	0%

#### WHERE AND WHEN TO VOTE?

- By-Mail Voting:**
- Ballot requests may be sent to:  
 Heather H. Hawthorne  
 Chambers County Clerk  
 P.O. Box 728  
 Anahuac, TX 77514
- Early Voting:**
- MAIN BRANCH**
    - October 22, 2007 – October 26, 2007 (8:00 A.M. – 5:00 P.M.)
    - October 29, 2007 – November 2, 2007 (8:00 A.M. – 5:00 P.M.)
    - Office of the County Clerk  
 Chambers County Courthouse  
 404 Washington Ave.  
 Anahuac, TX 77514
  - WINNIE BRANCH**
    - October 29, 2007 – November 2, 2007 (8:00 A.M. – 5:00 P.M.)
    - Justice of the Peace, Pct No. 4 Courtroom  
 East Chambers County Courthouse Annex  
 211 Broadway Avenue  
 Winnie, TX 77665
  - EAST CHAMBERS ISD BRANCH**
    - October 29, 2007 – November 2, 2007 (8:00 A.M. – 5:00 P.M.)
    - East Chambers ISD Administration Building  
 Administration Office  
 1955 State Hwy 124  
 Winnie, TX 77665
  - MONT BELVIEU BRANCH**
    - October 29, 2007 – November 2, 2007 (8:00 A.M. – 5:00 P.M.)
    - Justice of the Peace, Pct No. 4 Courtroom  
 West Chambers County Courthouse Annex  
 10616 Eagle Drive  
 Mont Belvieu, TX 77580
  - CEDAR BAYOU BRANCH**
    - October 22, 2007 – October 26, 2007 (8:00 A.M. – 5:00 P.M.)
    - October 27, 2007 (7:00 A.M. – 7:00 P.M.)
    - October 28, 2007 (1:00 P.M. – 6:00 P.M.)
    - October 29, 2007 – November 2, 2007 (7:00 A.M. – 7:00 P.M.)
    - Justice of the Peace, Pct No. 6 Courtroom  
 Cedar Bayou Community Building  
 7711 Hwy 146  
 Cedar Bayou, TX 77520
- Election Day:**
- November 6, 2007 (7:00 A.M. – 7:00 P.M.)  
 County Election Precincts #7 and #12  
 Winnie Stowell Community Building  
 335 Park Street  
 Winnie, TX 77665